

Vor Auslegung einer automatisierten Verarbeitung des Teils sollte Rücksprache mit Fa. A.Raymond gehalten werden.  
 Fully automatic processing of the part requires prior consultation with A.Raymond GmbH.

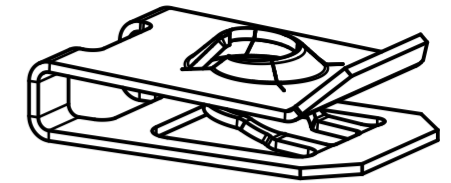

3D-Ansicht /  
 isometrical view  
 2:1

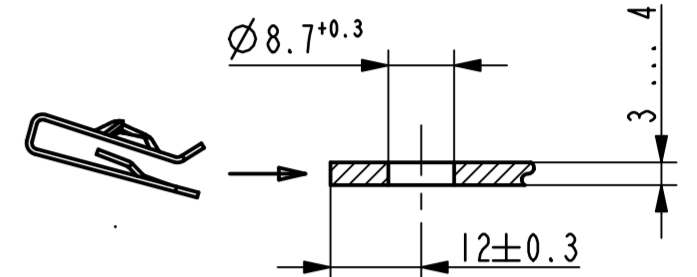

Einbausituation /  
 assembly situation  
 1:1

Ac	lx	Oberflaechenvariante hinzugefuegt, entfernt (3300, 7423)	28.12.10	mj
Rev.	Anzahl/ quality	Aenderungsbeschreibung / modification description	Datum/date	Name
				Teichstrasse 57 Germany - 79511 Loerrach Phone +49 (0) 7621 174-0 Fax +49 (0) 7621 174-225

Bei Verständnisproblemen beantragen Sie bitte beim Absender die deutsche Fassung vor jeder Anwendung.  
**"CONDITIONS OF USE"**  
 This drawing and all information (the "Drawing") disclosed are the exclusive property of A.Raymond. By using this Drawing the Addressee acknowledges and accepts that this Drawing (1) is covered by A.Raymond' intellectual property rights or know-how and (2) is provided under the following conditions who represent a Deposit Agreement. This Drawing is for Addressee' internal use only limited to its estimation. Without prior written consent of A.Raymond, no permission or rights for any purpose, is hereby granted, such as, without any limitation, (1) the copy, in part or entirely, (2) and/or the presentation, in part or entirely, to any other third party outside the Addressee' company or in the company but with no interest (3) and/or the distribution of the Drawing, in part or entirely, in any medium (4) and/or the creation of any derivative work. In case of breach of these conditions, Addressee shall indemnify A.Raymond from and against all damages (compensatory or consequential), costs, expenses and charges, caused or arising out of or attributable to its willful misconduct, fraud, negligence, infringement of A.Raymond' intellectual property rights. If the Addressee does not accept these conditions, please notify A.Raymond' sender immediately.

Intellectual property rights	vorbehalten / all rights reserved		Classification code	AABAG
Ersatz fuer/ substitute for	014312.c.01/Ab/27.11.2006	Entw.Ref./ dev.ref.	Projekt-Nr./ project no.	
Masstab/ scale	5:1	Allgemeintoleranz/ general tolerance	Datum/ date	
Format	A2	±0.25 / ±5°	Erstellt von/ prepared by	
Projektion / projection	ALL DIMENSIONS ARE IN MILLIMETERS		Freigegeben/ approved	
Blechkodex/ mat. thickness DIN EN 10140	0.70	Volumen/ volume (mm³)	417.1	Gewicht/ weight (g)
Oberfl./ finish	metallhaltige Korrosionsschutzbeschichtung, Farbe silber metallic corrosion protection coated, colour silver			Oberfl. Code/ finish code
Werkstoffbehandl./ material treatment	zwischenstufenverguetet / austempered 375 ... 475 HV 5			5410
Werkstoff/ material	C67S DIN EN 10132-4			Mat. code 1000

Bezeichnung/  
 title  
**Blechmutter**  
 fuer Gewinde EN ISO 1478 - ST 6.3, selbstsichernd  
 sheet metal nut  
 for thread EN ISO 1478 - ST 6.3, selflocked

Teil-Nr./  
 part no. **014312-0-02** Drawing type  
**C:Customer**

Kundenteile-Nr. / customer part no. - Blatt / sheet 1 / 1  
 CAD system & version ProE WF4 Dateiname / filename 014312-0C00

(Ac)	014312-0-07	metallhaltige Korrosionsschutzbeschichtung, Farbe schwarz, GZ metallic corrosion protection coated, colour black, lubricated	5453
	014312-0-06	metallhaltige Korrosionsschutzbeschichtung, Farbe silber, GZ metallic corrosion protection coated, colour silver, lubricated	4001
	014312-0-05	metallhaltige Korrosionsschutzbeschichtung, Farbe silber, GZ metallic corrosion protection coated, colour silver, lubricated	4000
	014312-0-04	metallhaltige Korrosionsschutzbeschichtung, Farbe silber metallic corrosion protection coated, colour silver	5412
Teil-Nr. / part no.	Oberflaeche / Farbe / finish / colour		Oberfl. Code/ finish code
Ausfuhrung / Execution			