

Kennzeichnung:/Identification:  
 Hersteller - Code  
 Mfr. - Code

\* Masse sind bei eingedrücktem  
 Pruefstift  $\varnothing 12$  zu messen  
 Dimensions must be measured with  
 preassembled test pin  $\varnothing 12$

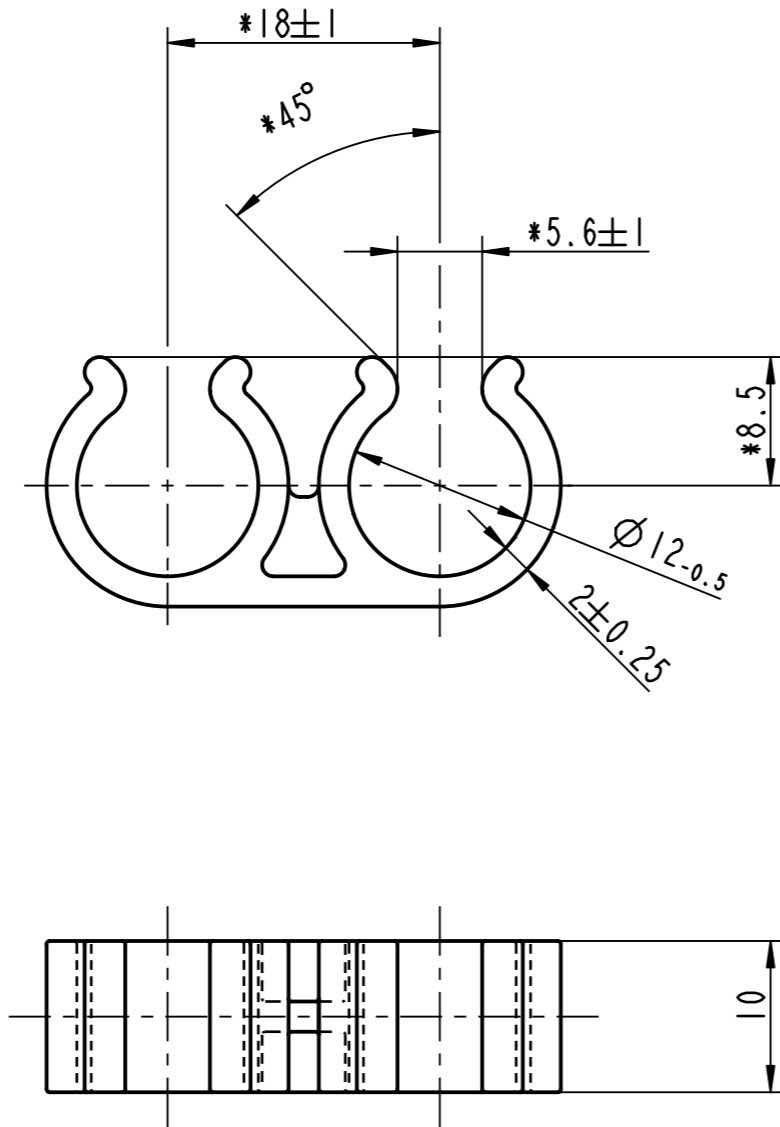

passend fuer Rohr- oder Schlauch- 2x  $\varnothing 12$   
 applicable for pipe- or hose 2x diameter 12

1:1

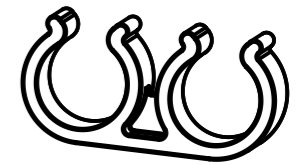

-	-	-	-	-	-	-	-	-	-
Cc	-	Zeichnung nach AR- Gruppenstandard ueberarbeitet; Teil unverändert;		11.05.12	fv				
Rev.	Anzahl/ quantity	Aenderungsbeschreibung / modification description			Datum/date	Name			
						Teichstrasse 57 Germany - 79511 Loerrach Phone +49 (0) 7621 174-0 Fax +49 (0) 7621 174-225			
Bei Verstaendnisproblemen beantragen Sie bitte beim Absender die deutsche Fassung vor jeder Anwendung. <b>"CONDITIONS OF USE"</b> This drawing and all information (the "Drawing") disclosed are the exclusive property of ARaymond. By using this Drawing the Addressee acknowledges and accepts that this Drawing (1) is covered by ARaymond' intellectual property rights or know-how and (2) is provided under the following conditions who represent a Deposit Agreement. This Drawing is for Addressee' Internal use only limited to its estimation. Without prior written consent of ARaymond, no permission or rights for any purpose, is hereby granted, such as, without any limitation, (1) the copy, in part or entirely (2) and/or the presentation, in part or entirely, to any other third party outside the Addressee' company or in the company but with no interest (3) and/or the distribution of the Drawing, in part or entirely, in any medium (4) and/or the creation of any derivative work. In case of breach of these conditions, Addressee shall indemnify ARaymond from and against all damages (compensatory or consequential), costs, expenses and charges, caused or arising out of or attributable to its willful misconduct, fraud, negligence, infringement of ARaymond' intellectual property rights. If the Addressee does not accept these conditions, please notify ARaymond' sender immediately.									
Schutzrechte/ patent rights				vorbehalten / all rights reserved		Classification Code		BBA--	
Ersatz fuer/ substitutue for		018900_C_02/Aa/23.04.2007		Entw.Ref./ dev.ref.		Projekt-Nr./ project no.			
Maassstab/ scale		Format		Allgemeintoleranz/ general tolerance		Datum/ date		11.05.2012	
2:1		A3		siehe Tabelle/see table		Erstellt von/ prepared by		Vogeler	
Projektion / projection		ALL DIMENSIONS ARE IN MILLIMETERS		Freigegeben/ approved		20120514115439			
		Bleedicke/ mat. thickness DIN EN 10140		-		Volumen/ volume (mm³)		1909 Gewicht/ weight (g) 2.70	
Oberfl./ finish		-						Oberfl. Code/ finish code	
Werkstoffbehandl./ material treatment		konditioniert / conditioned Wassergehalt / water content: 2 ... 4%							
Werkstoff/ material		PA 66 waermestabil PA 66 heat stabilized						Mat. code 2003	
Benennung/ title		Leitungshalter - cable clip -							
Teil-Nr./ part no.		018900-0-00						Drawing type C:Customer	
Kundenteile-Nr. / customer part no.		-						Blatt / sheet 1 / 1	
CAD system & version ProE WF4				Dateiname / filename 018900-0C01					

>400 <= 1000	±2
>120 <= 400	±1.5
> 30 <= 120	±1
> 6 <= 30	±0.5
<= 6	±0.25
Winkel / Angle	±3°
Allgemeintoleranzen fuer Nennmaesse ohne Toleranz. General tolerances for nominal dimensions without specified tolerance.	

<http://www.cergy-vis.fr>  
  
 ET SI ON PARLAIT SERVICE

Référence  
**018 900 001**  
 Matière Polyoxyméthylène Noir  
 (POM-Nr)

018900-0-00	schwarz black	SW	7000
Teil-Nr. / part no.	Oberflaeche / Farbe / finish / colour	Oberfl. Code/ finish code	Ausfuehrung / Execution